



Female Cyborg

 **ConcreteHead**

[VIEW IN BROWSER](#)

updated 16. 5. 2020 | published 16. 5. 2020

Summary

This is a bust i did in Zbrush . It's printed on a MK3S, then sanded and painted by myself.

[Art & Design](#) > [Sculptures](#)

This is a bust i did in Zbrush . It's printed on a MK3S, then sanded and painted by myself.

There are 3mf files for the SL1 and the STL's are for FDM Printers.
I scaled and aligned them to fit on the Buildplate for both printers.

I did not test the SL1 version so please check it yourself before printing!

I hope you like it and happy printing!

Model files

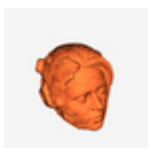

cyborghead.stl

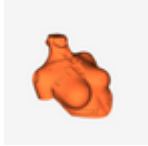

cyborgbody.stl

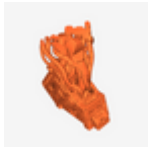

cyborgbase.stl

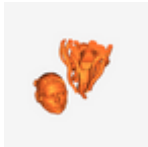

cyborg_sl1_head_hoses.3mf

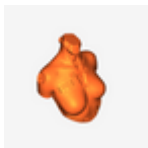

cyborg_sl1_body.3mf

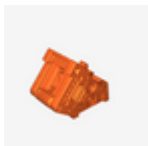

cyborg_sl1_base.3mf

License ©

This work is licensed under a
[Creative Commons \(4.0 International License\)](#)



Attribution—Noncommercial—No Derivatives

- ✗ | Sharing without ATTRIBUTION
- ✗ | Remix Culture allowed
- ✗ | Commercial Use
- ✗ | Free Cultural Works
- ✗ | Meets Open Definition