



## Filament Sample Box | Infill / Color Swatch | Remix



Extrutim

[VIEW IN BROWSER](#)

updated 26. 5. 2022 | published 24. 5. 2022

### Summary

This is my remix of the Filament Swatch Library by LinearRelation.

[3D Printers](#) > [Test Models](#)

Tags: [box](#) [color](#) [colors](#) [colour](#) [filament](#) [filamentsample](#)  
[infill](#) [library](#) [remix](#) [sample](#) [swatch](#) [test](#)

**This is a remix, the original design was created by [LinearRelation](#) and can be found [here](#).**

I have modified the model according to my wishes and additionally created a version which is printed in two parts and connected with **two M3x30** screws, as well as a version which fits on the **Prusa Mini** and one with only **20 slots** for samples. The other will hold **30 filament samples**. I enlarged the holes for the **four** magnets, now **6x3mm magnets** fit inside. For this, a **pause** is inserted in the slicer at a height of **22.2mm** and then the magnet inserted **with some glue or tape**.

I have slightly enlarged the filament samples, there are two versions. One version with different layer thicknesses to show the light transmission and a flat version from which you can make an infillsample. Print it with **5 wall lines** but **without top and bottom layers**.

Of course you can also use [the original samples](#) if you want to use the ettikets LinearRelation has linked.

Furthermore, the box was slightly widened, since the outer slots in the area of the magnetic closure were somewhat narrower. In addition, the cards are now guided in the front and back, so that it looks neater.

### **What you need:**

- 2 M3x30 screws, if you don't print the print-in-place version.
- 4 round 6x3mm magnets (make sure you insert them with the right polarity!)
- Some glue or tape to keep the magnets in place while the hotend moves over them.

**Tip:** You can also use shorter screws. Not ideal, but works as well.

**If you like check out [my other designs](#) too!**



**This remix is based on**



## Filament Swatch Library

by LinearRelation

### Model files



#### Box 30 Slots

5 files

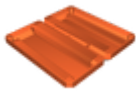

**box-printinplace.stl**

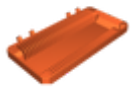

**samplebox-a.stl**

☐ Screws required.

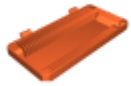

**samplebox-b.stl**

☐ Screws required.

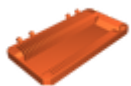

**prusamini-samplebox-a.stl**

☐ Fits on the Prusa Mini. Screws required.

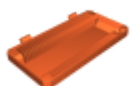

**prusamini-samplebox-b.stl**

☐ Fits on the Prusa Mini. Screws required.



#### Box 20 Slots

2 files

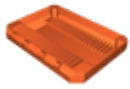

### 20slot-samplebox-a.stl

☐ Screws required.

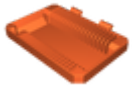

### 20slot-samplebox-b.stl

☐ Screws required.



## Samples

3 files

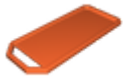

### sample.stl



### flat-infillsample.stl

☐ 5 wall lines, 0 top and bottom layers



### infillsample.3mf

☐ prepared settings

## License

This work is licensed under a  
[Creative Commons \(4.0 International License\)](https://creativecommons.org/licenses/by-nc-sa/4.0/)



**Attribution—Noncommercial—Share Alike**

- ✗ | Sharing without ATTRIBUTION
- ✓ | Remix Culture allowed
- ✗ | Commercial Use
- ✗ | Free Cultural Works
- ✗ | Meets Open Definition

