



Multi-Use Case with Inserts



James

[VIEW IN BROWSER](#)

updated 26. 7. 2022 | published 22. 7. 2022

Summary

A small, heavy duty case with a collection of inserts for different uses



3.27 hrs



2 pcs



0.20 mm



0.40 mm



PLA



36 g



Prusa MINI /
MINI+

[Hobby & Makers](#) > [Organizers](#)

Tags: [box](#) [organizer](#) [functional](#) [aa](#) [sd](#) [case](#) [container](#) [nozzle](#) [aaa](#) [sdcard](#) [microsd](#) [sdcardholder](#) [practicalprint](#) [practical](#) [divider](#) [nozzles](#) [nozzleholder](#) [e3dv6](#) [useful](#) [rigid](#) [batteryholder](#) [dividers](#) [practicalprinting](#) [aabbattery](#) [aabbatteryholder](#) [9volt](#) [9vbatterycase](#) [9vholder](#) [functionalprint](#) [microsdcardholder](#) [heavyduty](#) [batterycase](#) [strong](#) [aabbattery](#) [aabbatteryholder](#) [microsdholder](#) [multifunction](#) [ruggedcase](#) [rugged](#) [aabbatterystorage](#) [9vbattery](#) [sdcardcase](#) [aabbatterycase](#) [multifunctional](#) [microsdcardcase](#) [practicalprints](#) [practicaldesign](#)

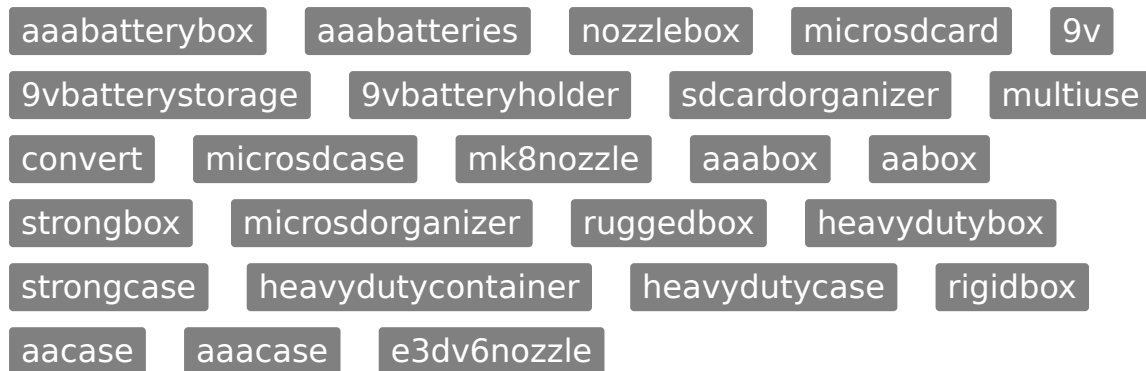

A small, strong case with a collection of optional inserts for different uses.

Case

Use a section of 1.75mm filament inside the hinge to connect the lid to the base. This can be a standalone case or you can add inserts for more functionality. As requested, I have included the following lids with text to label the contents of your case:

- Blank Lid (default and easiest to print)
- AA Lid
- AAA Lid
- 9V Lid
- Digital Media Lid
- Nozzle Lid

Print Settings

Base and Lid can be printed with 3 perimeters and 0% infill. Using these settings, most walls will be solid. The combined print time was just over 3 hours for me.

Optional Inserts

- Battery Holders
 - AA Holder - fits up to 6 AA batteries
 - AAA Holder - Version 1 fits up to 6 AAA batteries, Version 2 (currently untested) holds up to 8 batteries
 - 9V Holder - fits up to 2 9V batteries
- Digital Storage Holders - Can be used together or separately
 - MicroSD Card Holder - fits up to 12 MicroSD cards in the lower section
 - SD Card Holder - fits up to 6 SD cards in the upper section
- Dividers
 - Full Divider - Splits the entire case into 2 compartments

- Upper Divider - adds 2 compartments on top - Can be used with the Lower Divider
- Lower Divider - adds 2 compartments on bottom - Can be used with the Upper Divider
- Nozzle Holders - Can be used together or separately
 - Upper Nozzle Holder - fits 14 standard nozzles (MK8 or E3D V6)
 - Lower Nozzle Holder - fits 14 standard nozzles (MK8 or E3D V6)

Print Settings

No special print settings are needed for any of the inserts. I used 2 perimeters and 10% infill. Print times range from 35 minutes to 2 hours, depending on which insert(s) you choose to use.

The following filaments were used in the pictures above:

Black Case

- polymaker PolyTerra Charcoal PLA
- Hatchbox Sparkle Gray PLA

Red Case

- polymaker PolyTerra Army Red PLA
- polymaker PolyTerra Lava Red PLA

Yellow Case

- PrintBed Yellow PLA
- polymaker PolyTerra Banana PLA

Teal Case

- polymaker PolyTerra Arctic Teal PLA
- PrintBed Baja Blue PLA

Purple Case

- Prusament Galaxy Purple PLA
- Fillamentum Lilac PLA

Orange Case

- CC3D Flame Orange PLA+
- Inland Orange PLA

Green Case

- PrintBed Green PLA

- polmaker PolyTerra Forest Green PLA

Blue Case

- GIANTARM Matte Navy Blue PLA
- polmaker PolyTerra Sapphire Blue PLA

Model files



Case

2 files



base.stl

☐ Use a section of 1.75mm filament inside the hinge to two pieces of the case



lid.stl

☐ Use a section of 1.75mm filament inside the hinge to two pieces of the case



Battery Storage

4 files

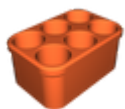

aa-insert.stl

☐ Holds up to 6 AA Batteries

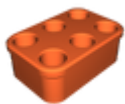

aaa-6-battery-insert.stl

☐ Holds up to 6 AAA Batteries



aaa-8-battery-insert.stl

☐ Holds up to 8 AAA Batteries



9v-insert-insert.stl

☐ Holds up to 2 9V Batteries



Digital Media Storage

2 files



upper-sd-card-insert.stl

☐ Holds up to 6 Full Size SD cards

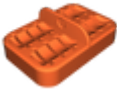

lower-microsd-insert.stl

☐ Holds up to 12 Micro SD cards



Nozzle Storage

2 files

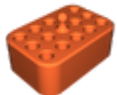

upper-nozzle-insert.stl

☐ Holds up to 14 MK8 or V6 nozzles



lower-nozzle-insert.stl

☐ Holds up to 14 MK8 or V6 nozzles



Dividers

3 files

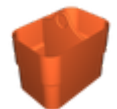

fulldivider.stl

☐ Splits the entire case into 2 compartments

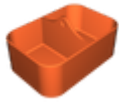

upper-divider-insert.stl

☐ Upper section divided into 2 compartments

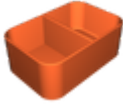

lower-divider-insert.stl

☐ Lower section divided into 2 compartments



Extra Lids

5 files



labeled-lid-aa.stl

☐ Optional lid with text

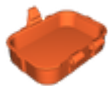

labeled-lid-aaa.stl

☐ Optional lid with text



labeled-lid-9v.stl

☐ Optional lid with text

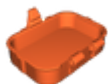

labeled-lid-digital-media.stl

☐ Optional lid with text

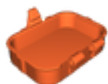

labeled-lid-nozzle.stl

☐ Optional lid with text

Print files



lid_02mm_pla_mini_1h0m.gcode

🌀 PLA 📏 0.40 mm 📐 0.20 mm ⌚ 1.01 hrs ⚖️ 11 g 🖨️ Prusa MINI / MINI+

📄 3 Perimeters, No Infill



base_02mm_pla_mini_2h16m.gcode

🌀 PLA 📏 0.40 mm 📐 0.20 mm ⌚ 2.26 hrs ⚖️ 25 g 🖨️ Prusa MINI / MINI+

📄 3 Perimeters, No Infill

License ©



This work is licensed under a
[Creative Commons \(4.0 International License\)](#)

Attribution-ShareAlike

- ✖ | Sharing without ATTRIBUTION
- ✓ | Remix Culture allowed
- ✓ | Commercial Use
- ✓ | Free Cultural Works
- ✓ | Meets Open Definition