



## SCARBO SVF1 Race Car Model



Ouky1991

[VIEW IN BROWSER](#)

updated 19. 5. 2022 | published 30. 4. 2022

### Summary

A formula one model with functioning doors, suspension, steering, shifting and moving engine pistons.

[Toys & Games](#) > [Vehicles](#)

Tags: [car](#) [jointed](#) [modular](#) [snaptogether](#) [toys](#) [noglue](#)  
[nosupports](#)

Scarbo SVF1 Model has functioning doors, suspension, steering, shifting and moving engine pistons. Based on a modern replica of 1967 Ferrari 312 Formula One.

No supports, except for the exhaust pipes. Everything is designed to be simply snapped together, no need for gluing or drilling. Alternative parts for Prusa mini are also available. **More info in the manual** in the download section.

The SVF1 is compatible with Soozafone's [Lucky 13 figure](#).

### Print settings

- **Material:** PLA (PETG only for the base frame, for easier snapping)
- **Infil:** 100% (Only parts I used 15% were the wheels)

- **Perimeters:** 4 (There are a lot of rods, pins and generally longer parts, where more perimeters could save some print time)
- **Layer height:** 0,2mm
- **Supports:** Only for the exhaust pipes
- **Brim:** There are custom ones for a few risky parts, so unless you have major problems with adhesion, you shouldn't use any.
- **Estimated print time:** 38 hours
- **Used filament:** Grey - 205g (69m), Black - 135g (46m), Red - 54g (18m). 394g in total according to Prusa slicer.





Edit: 2.5.2022 - There is no subfolder in the BLACK folder, fixed reference in the manual.

5.5.2022 - Fixed missing siderods from the BODYWORK folder.

11.5.2022 - Changed instructions picture for exhaust assembly (page 17)

19.5.2022 - Added some requested alternative parts

## Model files

	1_FRONT_AXLE	27 files
	2x_bodywork_pin.stl	
	steering_knuckle_l.stl	
	pedal_l.stl	
	steering_rod_l.stl	



**bodywork\_clip\_r.stl**



**wheel\_rod\_r.stl**



**pedal\_r.stl**



**lower\_control\_arm\_r.stl**



**front\_axle\_r.stl**



**steering\_gear.stl**



**wheel\_rod\_l.stl**



**upper\_control\_arm\_l.stl**



**steering\_rod\_r.stl**



**alt\_base\_frame\_2.stl**



**front\_axle\_group.stl**

---



**steering\_wheel\_frame.stl**

---



**upper\_control\_arm\_r.stl**

---



**bodywork\_clip\_l.stl**

---



**steering\_rod.stl**

---



**base\_frame.stl**

---



**steering\_wheel.stl**

---



**lower\_control\_arm\_l.stl**

---

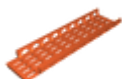

**alt\_base\_frame\_1.stl**

---



**2x\_steering\_pin.stl**

---



**alt\_base\_frame\_3.stl**



**front\_axle\_l.stl**



**steering\_knuckle\_r.stl**



**2\_REAR\_AXLE**

26 files



**rear\_control\_arm\_3l.stl**



**drive\_shaft\_holder.stl**



**shifting\_rod\_clip.stl**



**rear\_control\_arm\_1l.stl**



**securing\_pin\_r.stl**



**rear\_axle\_l.stl**



**drive\_shaft\_9r.stl**



**rear\_control\_arm\_2l.stl**



**shift\_stick\_clip.stl**



**drive\_shaft\_gear.stl**



**l\_shaped\_clip.stl**



**rear\_axle\_r.stl**



**rear\_control\_arm\_2r.stl**



**rear\_knuckle\_l.stl**



**rear\_axle\_group.stl**



**rear\_knuckle\_r.stl**



**shifting\_rod\_2.stl**



**shift\_stick\_cap.stl**



**rear\_clip.stl**



**shift\_stick\_holder.stl**



**rear\_control\_arm\_1r.stl**



**shift\_stick.stl**



**drive\_shaft\_9l.stl**



**rear\_control\_arm\_3r.stl**



**shifting\_rod\_1.stl**



**drive\_shaft\_cap.stl**



**3\_WHEELS**

11 files



**rear\_inner\_wheel\_r.stl**



**rear\_inner\_wheel\_l.stl**



**rear\_wheel\_l.stl**



**rear\_wheel\_r.stl**



**front\_inner\_wheel\_r.stl**



**front\_wheel\_l.stl**



**wheels\_group.stl**





**front\_wheel\_r.stl**



**2x\_front\_wheel\_brake\_disc.stl**



**front\_inner\_wheel\_l.stl**



**2x\_rear\_wheel\_brake\_disc.stl**



**4\_ENGINE**

18 files



**8x\_air\_intake.stl**



**2x\_side\_cover\_clip.stl**



**lower\_engine\_block\_l.stl**



**engine\_top\_cover.stl**



**8x\_piston.stl**



**engine\_gear.stl**



**lower\_engine\_block\_r.stl**



**exhaust\_holder.stl**

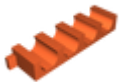

**cylinder\_block\_r.stl**



**crankshaft.stl**

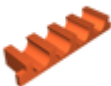

**cylinder\_block\_l.stl**



**back\_frame.stl**



**engine\_top\_rod.stl**



**front\_engine\_cover.stl**

**engine\_group.stl**



**engine\_side\_cover\_l.stl**



**engine\_side\_cover\_r.stl**

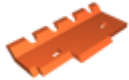

**8x\_connecting\_rod.stl**



**5\_BODYWORK**

8 files

**securing\_pin\_l.stl**



**door\_stopper.stl**



**2x\_side\_mirror.stl**



**upper\_siderod\_l.stl**





**lower\_siderod\_l.stl**



**upper\_siderod\_r.stl**



**lower\_siderod\_r.stl**



**bodywork\_group.stl**



**RED**

12 files



**door\_r.stl**



**cylinder\_head\_cover\_r.stl**



**door\_holder\_l.stl**



**rear\_bodywork\_l.stl**



**middle\_bodywork.stl**



**door\_l.stl**



**front\_bodywork.stl**



**door\_holder\_r.stl**



**rear\_bodywork\_r.stl**



**alt\_middle\_bodywork.stl**



**cylinder\_head\_cover\_l.stl**



**red\_group.stl**



**BLACK**

48 files



**drive\_shaft\_7l.stl**



**grooved\_front\_tire\_r.stl**



**black\_group.stl**

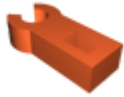

**drive\_shaft\_4l.stl**



**engine\_top\_l.stl**



**seat\_clip\_l.stl**

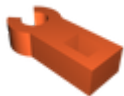

**drive\_shaft\_6r.stl**



**drive\_shaft\_3r.stl**



**smooth\_rear\_tire\_r.stl**

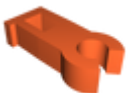

**drive\_shaft\_2r.stl**



**drive\_shaft\_1l.stl**

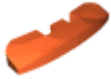

**dashboard.stl**



**drive\_shaft\_1r.stl**

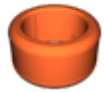

**grooved\_front\_tire\_l.stl**



**radiator.stl**



**seat\_r.stl**

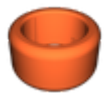

**smooth\_front\_tire\_l.stl**



**drive\_shaft\_5r.stl**



**drive\_shaft\_5l.stl**



**seat\_pin.stl**



**head\_rest.stl**

---

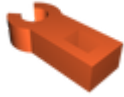

**drive\_shaft\_6l.stl**

---

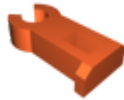

**drive\_shaft\_8r.stl**

---

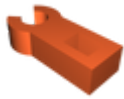

**drive\_shaft\_4r.stl**

---



**seat.stl**

---



**seat\_l.stl**

---

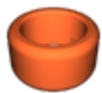

**smooth\_front\_tire\_r.stl**

---

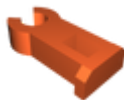

**drive\_shaft\_8l.stl**

---



**grooved\_rear\_tire\_l.stl**

---

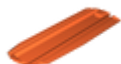

**door\_interior\_r.stl**

---



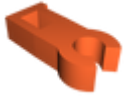

**drive\_shaft\_2l.stl**

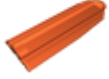

**door\_interior\_l.stl**



**exhaust\_rear.stl**



**engine\_top\_r.stl**



**drive\_shaft\_3l.stl**



**grooved\_rear\_tire\_r.stl**



**seat\_clip\_r.stl**



**drive\_shaft\_7r.stl**



**smooth\_rear\_tire\_l.stl**



**exhaust\_group.stl**



**exhaust\_3l.stl**



**exhaust\_2l.stl**



**exhaust\_4l.stl**



**exhaust\_3r.stl**



**exhaust\_1l.stl**



**exhaust\_1r.stl**



**exhaust\_2r.stl**



**exhaust\_4r.stl**



**Requested alternative parts**

4 files



**exhaust\_assembly.stl**



**alt\_door\_l.stl**



**alt\_door\_r.stl**



**alt\_front\_bodywork.stl**

## Other files



**scarbo-svf1-model.pdf**

## License



This work is licensed under a  
**Creative Commons (4.0 International License)**

**Attribution—Noncommercial—Share Alike**

- 
- ✗ | Sharing without ATTRIBUTION
  - ✓ | Remix Culture allowed
  - ✗ | Commercial Use
  - ✗ | Free Cultural Works
  - ✗ | Meets Open Definition

